

# PT043-WSP/WSK

## Outlet Dimension / 外觀尺寸

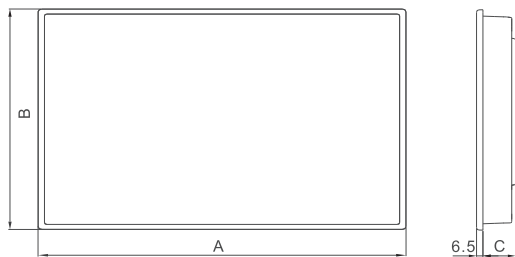

## Cut Out Dimension / 開孔尺寸

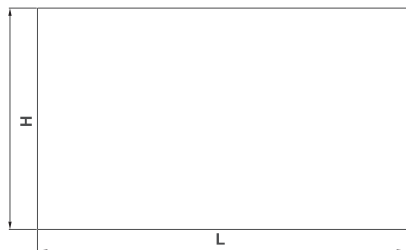

Model	A	B	C	L	H
PK043-WSP PK043-WSK	172.0mm	102.0mm	30mm	160.5mm	89.5mm

1

## Power Supply / 電源供應

**!** Powered by a Low Voltage / Limited Energy power source.  
以低電壓提供電力 / 限制能量電源。

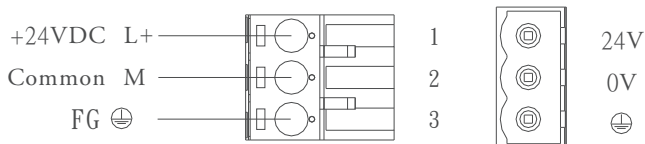

**!** Do not open the rear cover of the panel when power is applied.  
電源送電時請勿開啟後殼。

**!** Ensure that the power supply has enough power capacity for the operation of the equipment.  
送電時請確定電源設備的電源能力符合產品硬體規範。

## Function View / 功能配置圖

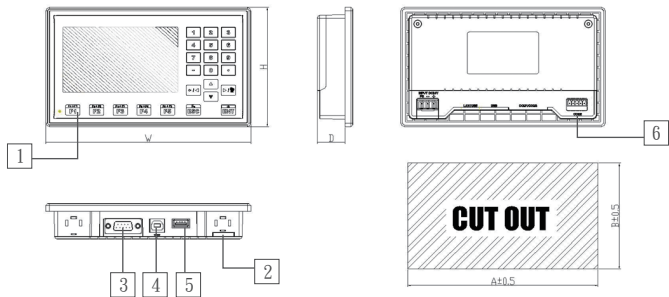

- 1 Front Function Key / 前置功能鍵
- 2 Power connector / 電源端子
- 3 COM1/COM3 9Pin Female / COM1/COM3 9Pin 母座
- 4 USB Client / USB接口
- 5 USB Host / USB接口
- 6 COM2 5Pin(Terminal) / COM2 5Pin (端子台)

2

## Installation Drawing / 安裝示意圖

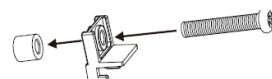
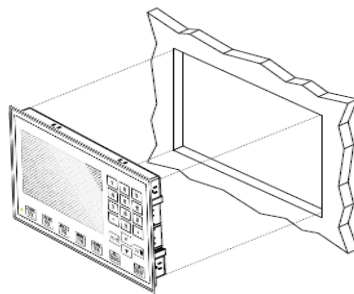

Fix Screw / 固定螺絲

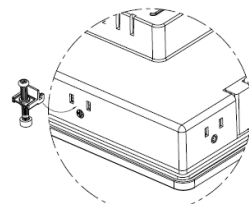

**!** Screw each fixing screw until the bezel corner gets in contact with the panel.  
使用固定螺絲固定時請注意不要鎖太緊，以避免壓迫造成其他問題。

## Battery / 電池

Model	VL2330
System	Vanadium pent-oxide lithium rechargeable battery
Nominal Voltage	3V
Nominal Capacity	50mAh
Nominal Discharge Current	0.1mA
Operating Temperature Range	-10 to +60 (°C)
Weight	2.8g
Dimensions	
Diameter	23mm
Height	3.0mm
UL Recognition	MH12210

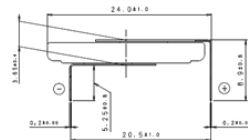
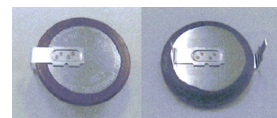

## Dispose of batteries / 電池處置

Maxcell/Panasnic 3V 50mAh Lithium Coin battery type.

**!** Dispose of batteries according to local regulations.  
廢棄電池的處置請依據使用者所在地對廢棄電池處置方式辦理。

3

## Pin Assignment of Serial Port / 串口接腳定義 (序列埠接腳定義)

COM1/COM2/COM3 9Pin Female / COM1/COM2/COM3 9Pin 母座					
Pin	COM1	Pin	COM2	Pin	COM3
1	RS-422 TXD+ / RS-485 D+	1	RS-422 TXD+ / RS-485 D+	7	RS-232 TXD/RS-485 D-
2	RS-232 RXD	2	RS-422 RXD+	8	RS-232 RXD/RS-485 D+
3	RS-232 TXD	3	RS-422 RXD-		
4	RS-422 RXD+	4	RS-422 TXD- / RS-485 D-		
5	SG	5	SG		
6	RS-422 TXD- / RS-485 D-				
9	RS-422 RXD-				

The products have been designed for use in an industrial environment in compliance with the 2004/108/EC directive.

本產品適用於工業環境並符合2004/108/EC規範。

The products have been designed in compliance with:

本產品符合以下法規:

- EN 61000-6-2
- EN 61000-6-4
- EN 61000-4-2
- EN 61000-4-3
- EN 61000-4-4
- EN 61000-4-5
- EN 61000-4-6
- EN 61000-4-8
- EN 61000-4-11

The installation of these devices into the residential, commercial and light-industrial environments are allowed only in the case that special measure are taken in order to get the conformity to IEC-61000-6-3

本產品若要安裝於住宅空間或商業及輕工業的環境時，必需加測特殊檢驗以符合IEC-61000-6-3

Reproduction of the contents of this copyrighted document, in whole or part without written permission of Cermate Technologies Inc., is prohibited.

本文件內容版權為Cermate Technologies Inc.所有,非經本公司同意,請勿自行重製、拷貝或修正文件內容。

4